

DIMENSIONAL

Versão Básica Standard

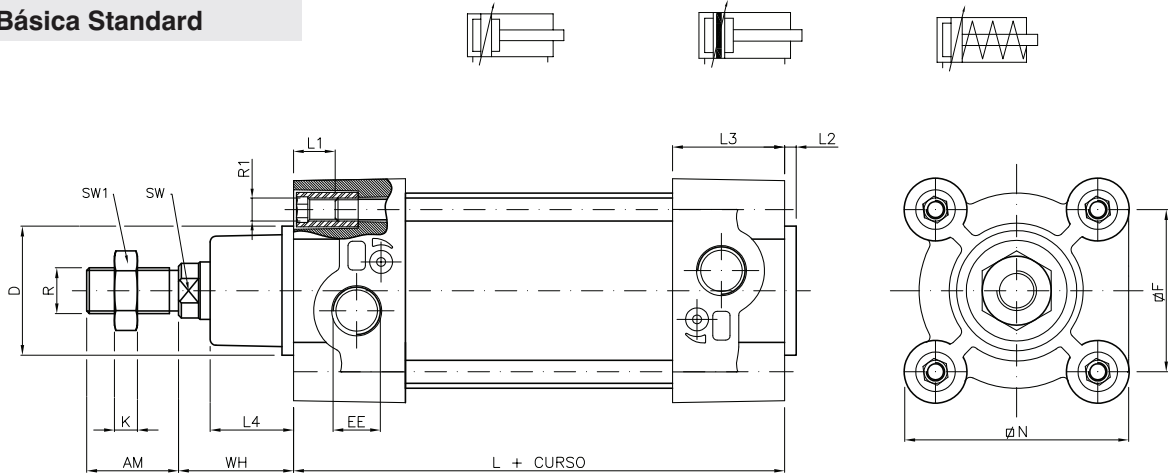

\varnothing CIL	\varnothing Haste	AM	\varnothing D	EE	\varnothing F	K	L	L1	L2	L3	L4	\varnothing N	R	R1	SW	Sw1	WH
32	12	22	30	G 1/8"	32,5	6	94	16	4	29	19,5	47	M10x1,25	M6x1	10	17	26
40	16	24	35	G 1/4"	38	7	105	16	4	29,5	22	53,5	M12x1,25	M6x1	13	19	30
50	20	32	40	G 1/4"	46,5	8	106	16	4	32,5	29	64,5	M16x1,5	M8x1,25	17	24	37
63	20	32	45	G 3/8"	56,5	8	121	16	4	39	29	78	M16x1,5	M8x1,25	17	24	37
80	25	40	45	G 3/8"	72	9	128	18	4	39	35	95,5	M20x1,5	M10x1,5	22	30	46
100	25	40	55	G 1/2"	89	9	138	18	4	44	35	114,5	M20x1,5	M10x1,5	22	30	51

Haste Passante

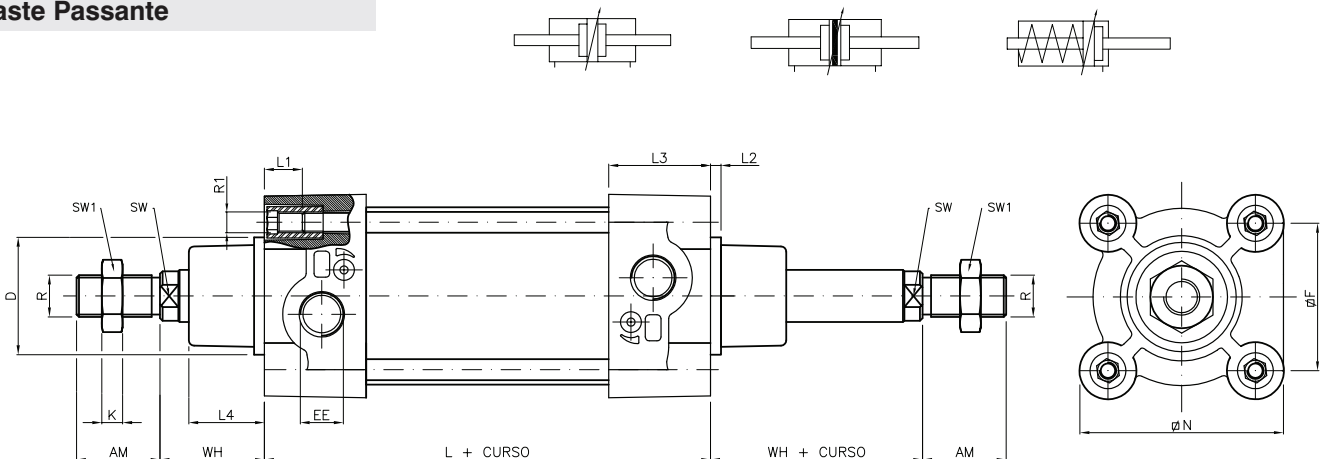

\varnothing CIL	\varnothing Haste	AM	\varnothing D	EE	\varnothing F	K	L	L1	L2	L3	L4	\varnothing N	R	R1	SW	Sw1	WH
32	12	22	30	G 1/8"	32,5	6	94	16	4	29	19,5	47	M10x1,25	M6x1	10	17	26
40	16	24	35	G 1/4"	38	7	105	16	4	29,5	22	53,5	M12x1,25	M6x1	13	19	30
50	20	32	40	G 1/4"	46,5	8	106	16	4	32,5	29	64,5	M16x1,5	M8x1,25	17	24	37
63	20	32	45	G 3/8"	56,5	8	121	16	4	39	29	78	M16x1,5	M8x1,25	17	24	37
80	25	40	45	G 3/8"	72	9	128	18	4	39	35	95,5	M20x1,5	M10x1,5	22	30	46
100	25	40	55	G 1/2"	89	9	138	18	4	44	35	114,5	M20x1,5	M10x1,5	22	30	51

DIMENSIONAL

Dimensional Versão Sanfona

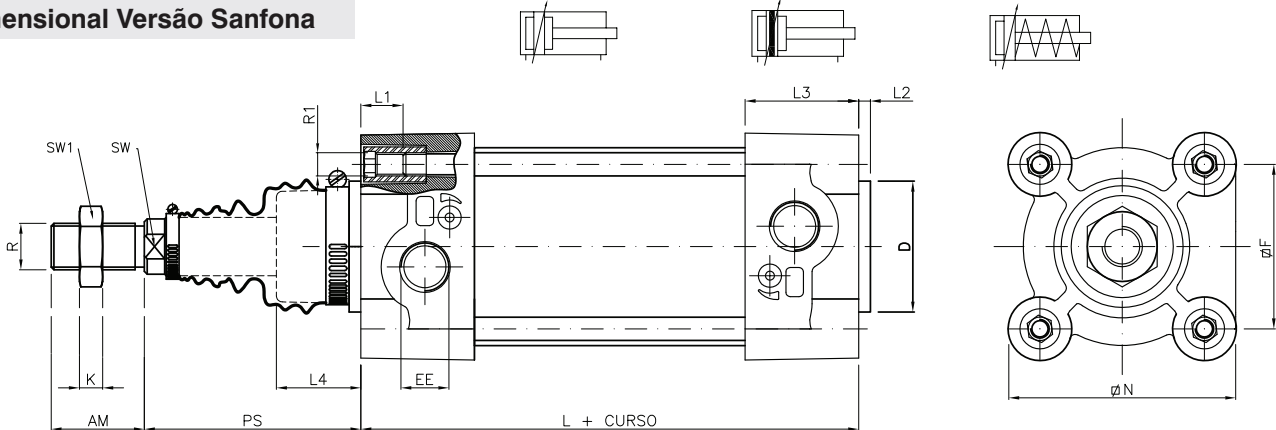

PS (PROLONGAMENTO SANFONA)

PS = WH + (0,25 x CURSO) - Sanf. Nylon

PS = WH + 30 + (0,25xCURSO) - Sanf. PVC

PS = Sob Consulta - Sanf. Borracha

ØCIL	ØHaste	AM	ØD	EE	ØF	K	L	L1	L2	L3	L4	ØN	R	R1	SW	Sw1	WH
32	12	22	30	G 1/8"	32,5	6	94	16	4	29	19,5	47	M10x1,25	M6x1	10	17	26
40	16	24	35	G 1/4"	38	7	105	16	4	29,5	22	53,5	M12x1,25	M6x1	13	19	30
50	20	32	40	G 1/4"	46,5	8	106	16	4	32,5	29	64,5	M16x1,5	M8x1,25	17	24	37
63	20	32	45	G 3/8"	56,5	8	121	16	4	39	29	78	M16x1,5	M8x1,25	17	24	37
80	25	40	45	G 3/8"	72	9	128	18	4	39	35	95,5	M20x1,5	M10x1,5	22	30	46
100	25	40	55	G 1/2"	89	9	138	18	4	44	35	114,5	M20x1,5	M10x1,5	22	30	51

Curso Regulável no Avanço

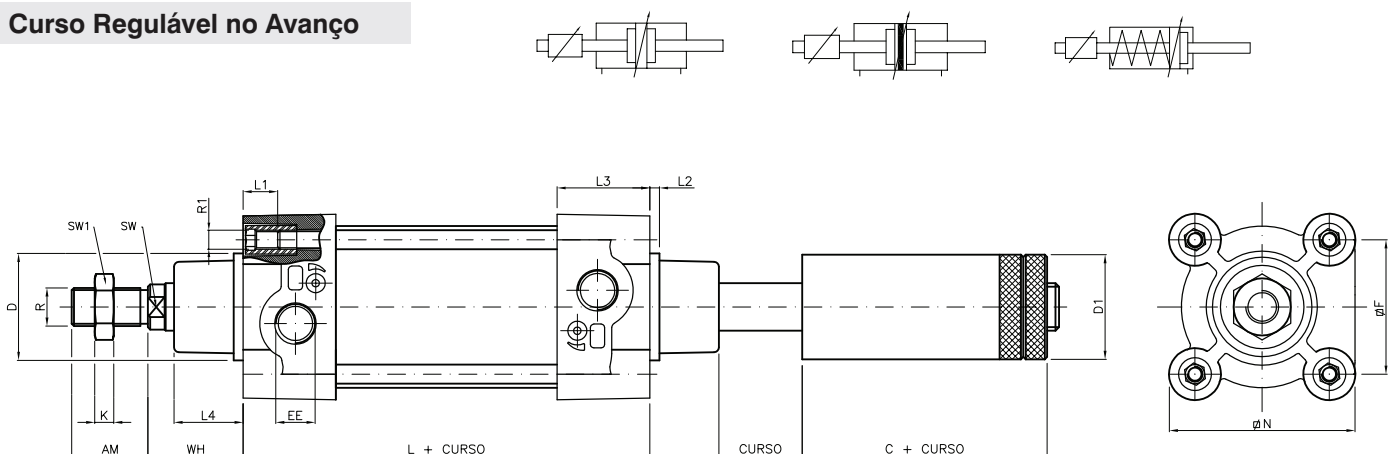

ØCIL	ØHaste	AM	C	ØD	ØD1	EE	ØF	K	L	L1	L2	L3	L4	ØN	R	R1	SW	Sw1
32	12	22	26,5	30	30	G 1/8"	32,5	6	94	16	4	29	19,5	47	M10x1,25	M6x1	10	17
40	16	24	29	35	35	G 1/4"	38	7	105	16	4	29,5	22	53,5	M12x1,25	M6x1	13	19
50	20	32	54	40	44	G 1/4"	46,5	8	106	16	4	32,5	29	64,5	M16x1,5	M8x1,25	17	24
63	20	32	54	45	44	G 3/8"	56,5	8	121	16	4	39	29	78	M16x1,5	M8x1,25	17	24
80	25	40	60	45	44	G 3/8"	72	9	128	18	4	39	35	95,5	M20x1,5	M10x1,5	22	30
100	25	40	60	55	44	G 1/2"	89	9	138	18	4	44	35	114,5	M20x1,5	M10x1,5	22	30

DIMENSIONAL

Dimensional Duplex Contínuo

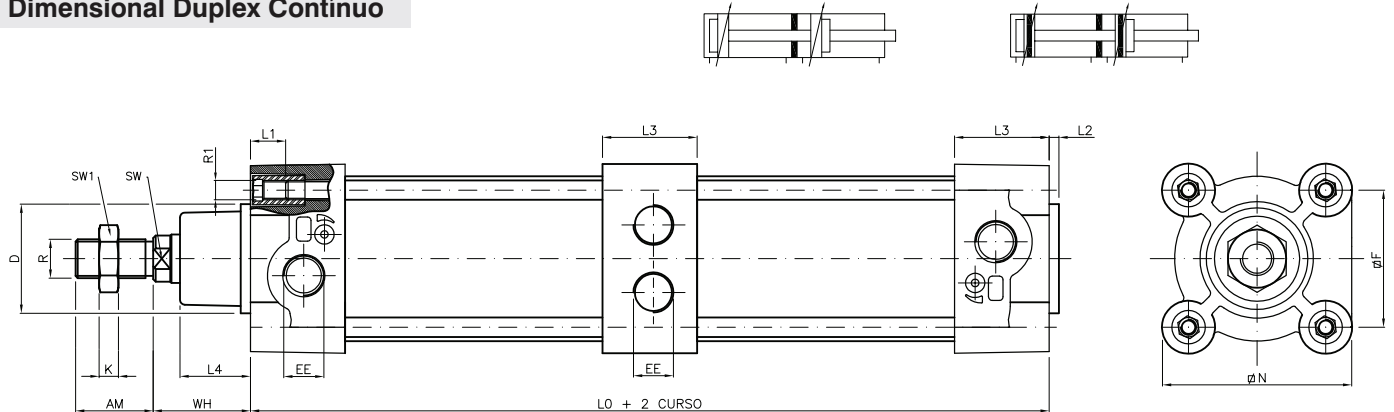

\varnothing CIL	\varnothing Haste	AM	\varnothing D	EE	\varnothing F	K	L0	L1	L2	L3	L4	\varnothing N	R	R1	SW	Sw1	WH
32	12	22	30	G 1/8"	32,5	6	159	16	4	29	19,5	47	M10x1,25	M6x1	10	17	26
40	16	24	35	G 1/4"	38	7	181	16	4	29,5	22	53,5	M12x1,25	M6x1	13	19	30
50	20	32	40	G 1/4"	46,5	8	180	16	4	32,5	29	64,5	M16x1,5	M8x1,25	17	24	37
63	20	32	45	G 3/8"	56,5	8	203	16	4	39	29	78	M16x1,5	M8x1,25	17	24	37
80	25	40	45	G 3/8"	72	9	217	18	4	39	35	95,5	M20x1,5	M10x1,5	22	30	46
100	25	40	55	G 1/2"	89	9	232	18	4	44	35	114,5	M20x1,5	M10x1,5	22	30	51

Dimensional Duplex Geminado

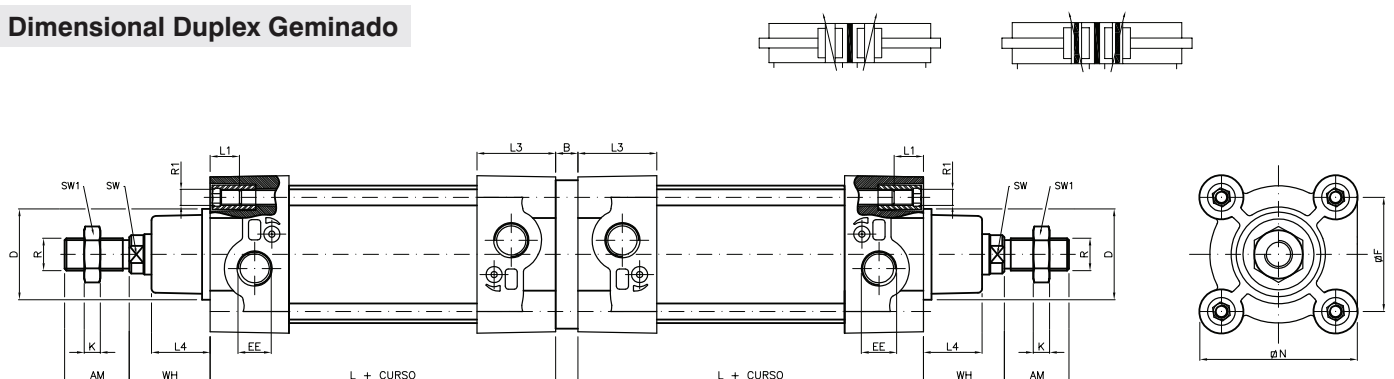

\varnothing CIL	\varnothing Haste	AM	B	\varnothing D	EE	\varnothing F	K	L	L1	L2	L3	L4	\varnothing N	R	R1	SW	Sw1	WH
32	12	22	11	30	G 1/8"	32,5	6	94	16	4	29	19,5	47	M10x1,25	M6x1	10	17	26
40	16	24	11	35	G 1/4"	38	7	105	16	4	29,5	22	53,5	M12x1,25	M6x1	13	19	30
50	20	32	13	40	G 1/4"	46,5	8	106	16	4	32,5	29	64,5	M16x1,5	M8x1,25	17	24	37
63	20	32	13	45	G 3/8"	56,5	8	121	16	4	39	29	78	M16x1,5	M8x1,25	17	24	37
80	25	40	13	45	G 3/8"	72	9	128	18	4	39	35	95,5	M20x1,5	M10x1,5	22	30	46
100	25	40	13	55	G 1/2"	89	9	138	18	4	44	35	114,5	M20x1,5	M10x1,5	22	30	51